

KNOWN

COLLECTION

Cleaning & Maintenance Guideline Stardust Collection Square Cut

A) Post Installation Cleaning

- When flooring installation is complete, and adhesive is fully cured:
 - Sweep floor to remove any debris, then dust mop thoroughly to remove all surface dust and dirt using a dust mop or microfiber mop.
 - Damp mop using a neutral PH cleaner diluted with warm water using a microfiber mop (see dilution rates on label).
 - Use a two-bucket system and change the water frequently.
 - Do not use any oil base cleaners as they will deteriorate the mats.
 - If floor has been unprotected during construction and an excessive amount of dirt or dust is present additional cleaning with an auto scrubber may be required.
 - An RPM of 185 and brush pressure between 35lbs and 85lbs is recommended.
 - If disc type equipment is used, be sure to use a soft nylon brush, not a pad.
 - Do not flood floor.
 - Allow to dry thoroughly.
 - Apply a treatment of DinoCoat according to instruction provided by Known Collection.

B) General Maintenance

Sealed/Non-Sealed Floors

- Typically, Known Collection products require less maintenance than other types of flooring.
 - Sweeping then damp mopping with a microfiber mop is the preferred method.
 - Do not use a string mop
 - Use a two-bucket system with a neutral PH cleaner and change water frequently.
 - Products containing solvents and acids will attack the composite structure of the rubber flooring and cause deterioration.
 - Sealants, waxes, etc. can alter the surface characteristics and appearance.
 - Known Collection does not assume any responsibility for damages caused by chemical additives.
 - A protective coating such as DinoCoat is required for Stardust products, be sure to apply a coating after cleaning.

C) Floor Treatment

- Please note that treating Stardust Collection products is required.
 - Stardust products must be coated with DinoCoat. Any Stardust Collection installations that are not coated will not be covered under warranty.
- Mats with a predominance of light-colored EPDM will be easier to clean and maintain if treatment is applied.
- DinoCoat will protect the cork granules in the product and is recommended to improve the visual effects of shade variation and uneven distribution of color granules.
- Please follow the below application guide to reapply the coating.
 - Preparation:
 - Ensure floor has been completely cleaned and free of any dust, dirt or debris.
 - Ensure floor is completely dry before applying DinoCoat.
 - Isolate or close off area(s) that will have DinoCoat applied
 - Line mop bucket with garbage bag to eliminate DinoCoat from entering the bucket and eliminate the possibility of foreign substance or unwanted chemicals
 - Applying DinoCoat:
 - Pour DinoCoat into a bucket, using a roller or microfiber mop and slightly wringing it out so the mop is fully saturated but not dripping.
 - Apply a thin coat starting at the entrance way and outline the room along the baseboards, do a 180° turn back to the 3rd wall and cover the rest of the area working back and forth. (See below image)
 - Set up all caution/wet floor signs to ensure there is no traffic on floor while DinoCoat is drying.
 - DinoCoat must be completely dry before applying subsequent coats (minimum 1 hour). Drying times will vary with temperature, humidity, and ventilation.
 - When applying a second coat, be sure to move in opposite direction from first coat.

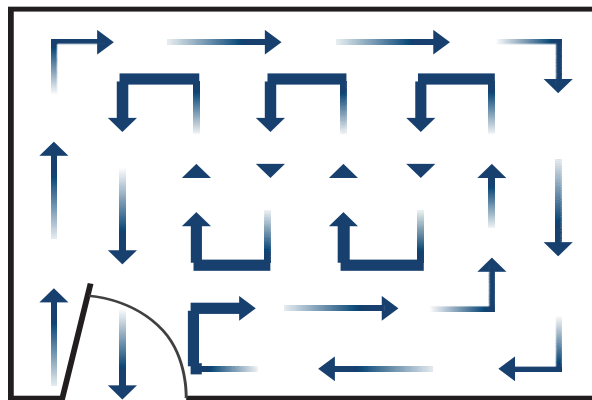

For additional information, please contact your Known Collection Representative, or for additional technical assistance, contact Known Collection.